



Line Interactive UPS

PRO851SFC/SFCU



Super Fast Charging



True AVR



Wide Input Voltage



Overload Protection



Over Temperature Protection



Surge Protection



Early Shutdown Warning System



Universal Socket

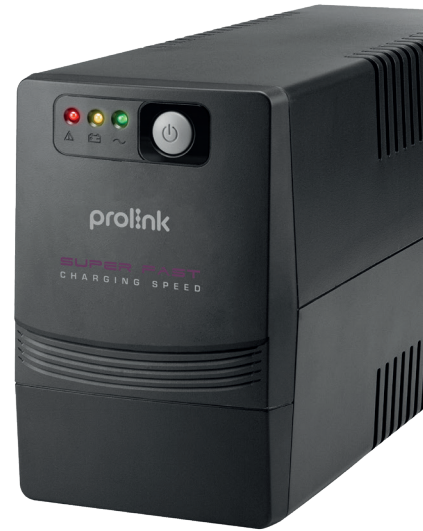

The **PRO851SFC/SFCU is a single-phase input/ single-phase output Line-Interactive 850VA UPS** is a single-phase input/ single-phase output Line-Interactive UPS system with PROLiNK's latest Super-Fast Charging technology. This cutting-edge technology is able to recharge the battery back to 90% of its capacity within 2-4 hours, perfect for areas with intermittent power.

Advance Early Warning system immediately alerts you to an output overload, high temperature or low battery condition, giving you ample time to either correct the condition or shut down your system before battery time runs out.

Intelligent Battery Management system provides additional protection for battery overcharging or deep discharging, while maximizing battery performance, life and reliability through intelligent precision charging. In the event of over temperature and overload, the device will automatically shutdown to prevent any damage from occurring.

Lastly, this device is supported with a wide input voltage range. The unit also comes with universal sockets to provide better compatibility with a wider range of connected devices.

PRO851SFC/SFCU is an ideal solution for safe and stable backup power to home/ small office applications.

Key Features

- Built-in super fast charger, battery can be recharged to 90% of its capacity within 2-4 hours
- Excellent microprocessor control guarantees high reliability
- Boost and buck AVR for voltage stabilization
- Auto restart while AC is recovering
- Simulated sine wave
- Off-mode charging
- Cold start function
- RJ11 ports (Fax/Modem Protection)
- Optional USB communication port
- Optional HID Compliant USB (for PRO851SFCU)

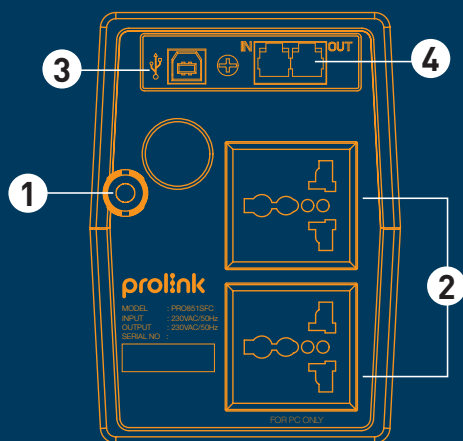

Legend:

1. Power AC Input
2. Backup Outlets
3. USB Port (Only for PRO851SFCU)
4. RJ11 Ports

Specifications

Capacity		850VA
Input	Voltage Range Frequency Phase	140 ~ 300VAC \pm 5% 50Hz/60Hz (Auto-sensing) Single + GND
Output	Voltage Range Battery Mode Frequency Waveform Transfer Time	230VAC +12% - 14% 230VAC \pm 10% 50Hz \pm 1% (Battery mode) Simulated sine wave (Battery mode) Sine wave (AC mode) 2ms typical
Battery	Type Backup Time Recharge Time	12V/10AH - 1pc 8 - 30 mins depending on load 2 - 4 hours recover to 90% capacity
Protection/ Monitoring	Short Circuit Protection Surge Protection Alarm Overload Protection Intelligent Battery Management	Yes (Line mode & battery mode) Yes Audible & Visual Line mode : 100 - 120% 5 mins change to fault mode >120% change to fault mode immediately Battery mode : 100 - 120% 5 secs shutdown >120% shutdown immediately Prevent overcharging of battery Protect battery and prolong battery life
Interface	RJ11 Ports USB Connector*	Modem/Fax Protection AC fault, battery low, shutdown UPS
General	Noise Level Temperature Humidity Power Factor Built-in AVR	<40dB 0°C - 40°C 0 - 90% Up to 0.7 TRUE Full AVR (3 steps)
Physical	Dimension (D x W x H) Weight	279 x 101 x 142 4.9kg

#Only applicable for Model PRO851SFCU.

Ver1.0_23.04.2021

Comteck Computer Technology 1994
sales@comteck.com.sg

Compatible with:



System Requirements:
Windows XP/Vista/7/8/10, Mac, Linux

Prolink is a registered trademark of Fida International (S) Pte Ltd. Other brands and product names are trademarks or registered trademarks of their respective holders. Product images are purely for illustrative purposes and may differ from the actual product. Specifications are subjected to changes without prior notice. Copyright © 2021 Fida International (S) Pte Ltd.